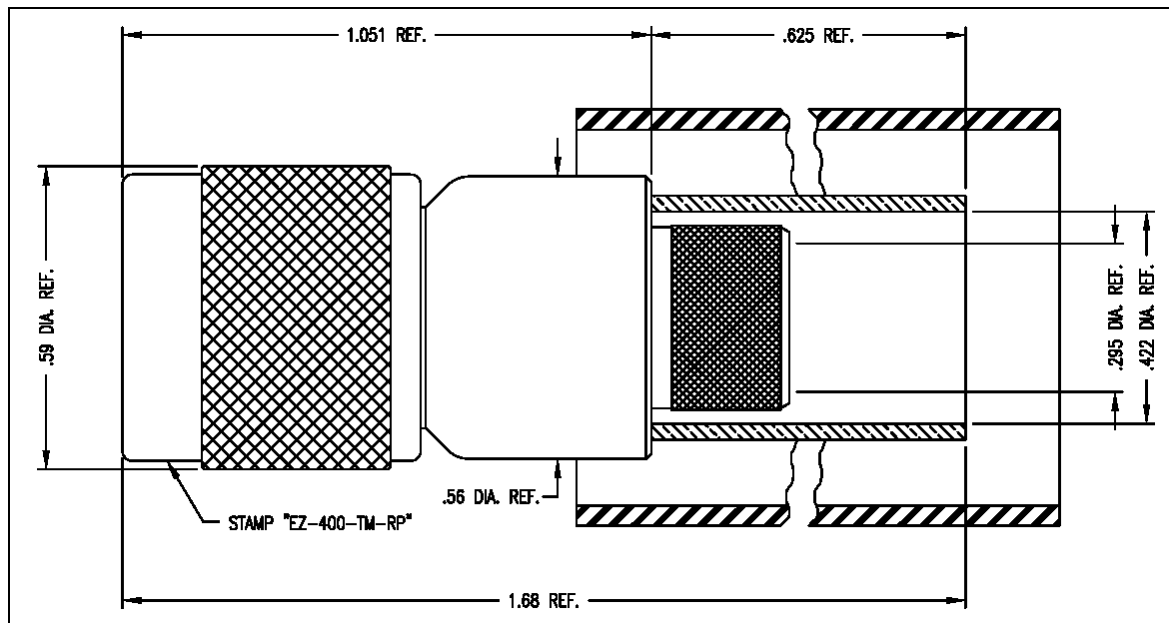

LTR	DESCRIPTION	DATE	BY
-	Released	6/14/99	JCL

**I. MATERIALS & FINISHES**

center contact: Gold Plated Beryllium Copper – female pin  
 outer contact: Alballoy Plated Brass  
 body: Alballoy Plated Brass  
 coupling nut: Alballoy Plated Brass  
 crimp sleeve: Alballoy Plated Copper  
 dielectric: Teflon® PTFE  
 gasket: Silicone Rubber  
 shrink sleeve: Adhesive Lined Polyolefin  
 crimp size: .429" hex (M22520/5-61)

**II. ELECTRICAL PROPERTIES**

impedance: 50 ohms  
 working voltage: 500 vrms (max)  
 vswr: 1.25:1 (max) up to 3 GHz  
 insertion loss:  $0.1 \times \sqrt{f_{ghz}}$

Unless otherwise specified, dimensions are in inches. Tolerances are applicable when specified.

These drawings and specifications contain proprietary information which is the property of Times Microwave Systems.

**Approvals**

Drawn	JCL	6/14/99
-------	-----	---------

Check		
-------	--	--

Prj. Mgr.		
-----------	--	--

Prd. Mgr.		
-----------	--	--

QA Mgr.		
---------	--	--

**TIMES MICROWAVE SYSTEMS**

Wallingford, CT 06492  
 (203) 949-8400; (203) 949-8423.Fax  
 www.timesmicrowave.com

**EZ-400-TM-RP**  
**Reverse Polarity TNC Male (female pin)**  
**for LMR-400 Cable**

Size A	CAGE CODE <b>68999</b>	Drawing No.: <b>3190-794</b>
-----------	---------------------------	---------------------------------

Scale: NA

Rev. ( )

Sheet: 1 of 1