

Product data sheet

Automation technology - Solenoid valve connectors



Product description	Female solenoid valve connector, Contacts: 2+2PE, unshielded, moulded on the cable, IP67, PUR, black, Circuit Z20, with LED PNP closer, 3 m
Area	-
Part no.	Size A series 210 31 5237 300 520

Illustration



Pin assignment plans

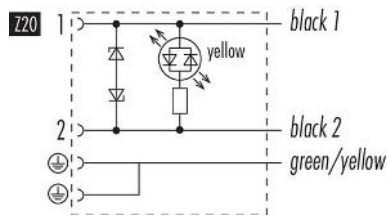

Scale drawing

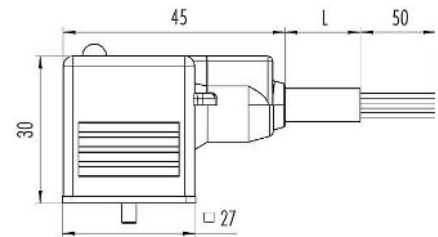

Contact arrangement (Plug-in side)

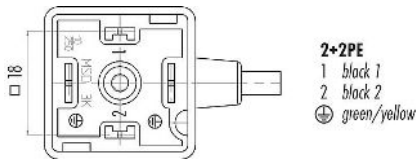

Technical data

General features

Part no.	31 5237 300 520
	Alternative part no.: 31 1313 300 520
Notice	Please note that, due to the change from the old to the new order number, there may be deviations in the technical specifications. For questions about product details, please use the 'Contact Customer Service' form on the right.
Connector design	Female solenoid valve connector
Type standard	DIN EN 175301-803
Cable length	3 m
Version	Female solenoid valve connector
Connector locking system	Central bolt
Termination	moulded on the cable
Degree of protection	IP67
Cross-sectional area	0.75 mm ² / AWG 18
Temperature range from/to	-25 °C / 80 °C
Mechanical operation	> 50 Mating cycles
Additional information	Circuit Z20 with LED PNP closer
Weight (g)	199.00
Customs tariff number	85444290
Country of Origin	CZ

Product data sheet

Automation technology - Solenoid valve connectors



Product description	Female solenoid valve connector, Contacts: 2+2PE, unshielded, moulded on the cable, IP67, PUR, black, Circuit Z20, with LED PNP closer, 3 m
-	-
Area	Size A series 210
Part no.	31 5237 300 520

Electrical parameters

Rated voltage	24 V
Rated impulse voltage	4000 V
Rated current	10.0 A
Insulation resistance	$\geq 10^{10} \Omega$
Pollution degree	3
Overvoltage category	III
Insulating material group	I
EMC compliance	unshielded
Wiring	Z20

Material

Housing material	PBT
Contact body material	PA
Contact material	CuSn (bronze)
Contact plating	Sn (tin)
REACH SVHC	CAS 7439-92-1 (Lead)
SCIP number	65f34ed2-dec2-470d-a7c6-07954a6c3feb

Classifications

eCl@ss 11.1	27-06-03-11
ETIM 9.0	EC002638

Declarations of conformity

RoHS Directive	2011/65/EU (EN 50581:2012)
----------------	----------------------------

Cable data - Structure of the cable

Cable diameter	6.0 mm
Sheath material	PUR
Single-lead structure	3 x 0.75 mm
Cable color	black

Cable data - Other features

Halogen free	yes
--------------	-----

Product description	Female solenoid valve connector, Contacts: 2+2PE, unshielded, moulded on the cable, IP67, PUR, black, Circuit Z20, with LED PNP closer, 3 m
-	-
Area	Size A series 210
Part no.	31 5237 300 520

General Disclaim Notice

The connectors have been developed for applications in plant engineering, control and electrical equipment construction. The user is responsible for checking whether the connectors can also be used in other areas of application.

The user must take appropriate safety precautions to ensure that the connector cannot be accidentally disconnected. In addition, the user must ensure that the cable is suitably secured.