

Product Area	Female receptacle for PCB assembly, angled M12 connectors B-Coding	serie 715/766	Pole	5
			Article number	99 4442 601 05

illustration

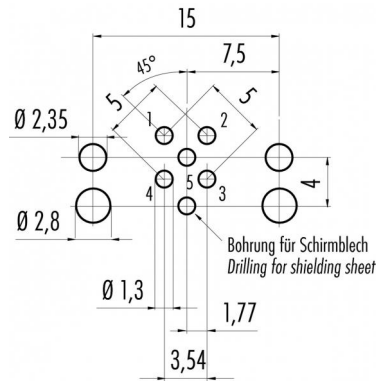

Conductor layout



scale drawing

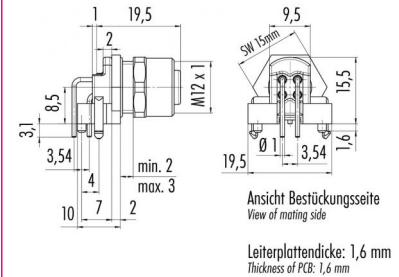

You can find the assembly instruction on the next page.

Technical data

Common values

Connector Design	Female socket
Connector locking system	Screw
Wire gauge (mm)	-
Wire gauge (AWG)	-
Upper temperature	+85 °C
Lower temperature	-40 °C

Material

Material of contact	CuSn (bronze)
Contact plating	Au (gold)
Material of contact body	PA
Material of housing	CUZn (brass nickel plated)

Electrical values

Rated voltage	125 V
Rated impulse voltage	1500 V
Pollution degree	3
Overvoltage category	II
Material group	II
Rated current (40°C)	4 A
Volume resistivity	≤ 3 mΩ
Degree of protection	IP 68
Mechanical operation	>100 mating cycles

Cable data

material housing	-
insulation single lead	-
single lead structure	-
conductor resistance	-
bending radius cable fixed	-
bending radius cable movable	-

Contacts: 5, female receptacle for PCB assembly, angled, with shielding sheet



Product Area Female receptacle for PCB assembly, angled
M12 connectors B-Coding

serie 715/766

Pole 5
Article number 99 4442 601 05

Date: 2014-07-20 - Page 2 of 2

Installation instructions / Mounting cutout

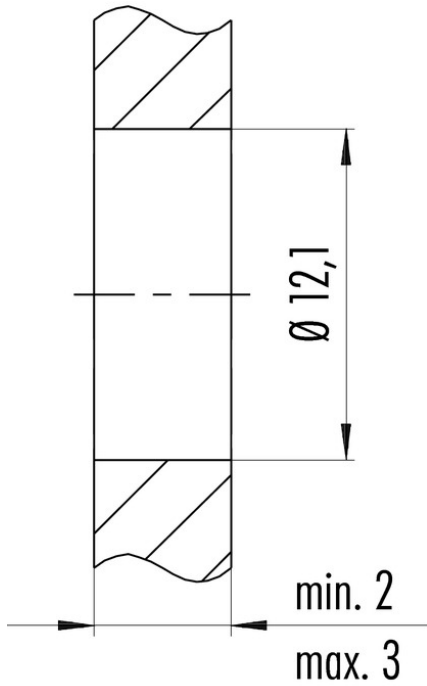

Anzugsdrehmoment/*Tightening moment*
M12 x 1 6,25 Nm