

Product Area Female receptacle for PCB assembly, angled  
M12 connectors D-Coding

serie 825/876

Pole 4  
Article number 99 3732 202 04

illustration



Conductor layout

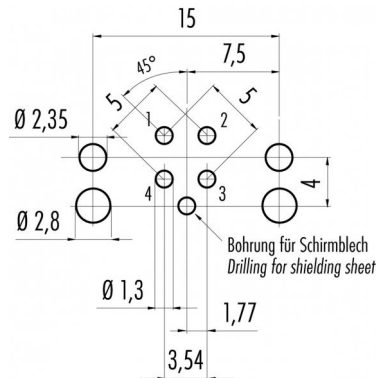

scale drawing

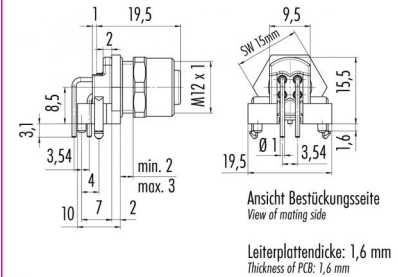

Contact Arrangement

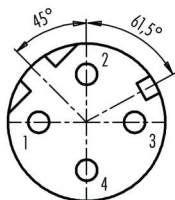

|   | X     | Y     |
|---|-------|-------|
| 1 | -2,50 | 0,00  |
| 2 | 0,00  | 2,50  |
| 3 | 2,50  | 0,00  |
| 4 | 0,00  | -2,50 |

You can find the assembly instruction on the next page.

Technical data

Common values

|                          |               |
|--------------------------|---------------|
| Connector Design         | Female socket |
| Connector locking system | Screw         |
| Termination              | dip solder    |
| Wire gauge (mm)          | -             |
| Wire gauge (AWG)         | -             |
| Upper temperature        | +85 °C        |
| Lower temperature        | -40 °C        |

Electrical values

|                       |                    |
|-----------------------|--------------------|
| Rated voltage         | 250 V              |
| Rated impulse voltage | 2500 V             |
| Pollution degree      | 3                  |
| Overvoltage category  | II                 |
| Material group        | II                 |
| Volume resistivity    | ≤ 3 mΩ             |
| EMV compliance        | not shielded       |
| Degree of protection  | IP 67              |
| Mechanical operation  | >100 mating cycles |

Material

|                          |                            |
|--------------------------|----------------------------|
| Material of contact      | CuSn (bronze)              |
| Contact plating          | Au (gold)                  |
| Material of contact body | PA                         |
| Material of housing      | CUZn (brass nickel plated) |

Cable data

|                              |   |
|------------------------------|---|
| material housing             | - |
| insulation single lead       | - |
| single lead structure        | - |
| conductor resistance         | - |
| bending radius cable fixed   | - |
| bending radius cable movable | - |

Contacts: 4, female receptacle for PCB assembly, angled



Product Area Female receptacle for PCB assembly, angled  
M12 connectors D-Coding

serie 825/876

Pole 4  
Article number 99 3732 202 04

Date: 2014-07-20 - Page 2 of 2

Installation instructions / Mounting cutout

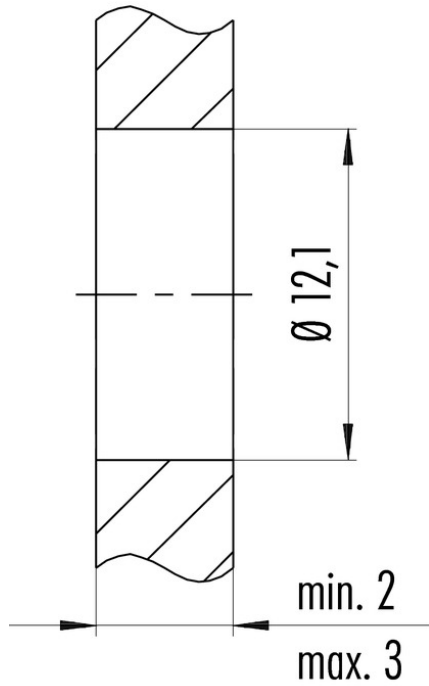

Anzugsdrehmoment/Tightening moment  
M12 x 1 6,25 Nm