

|              |   |                |               |
|--------------|---|----------------|---------------|
| Product Area | Male cable connector moulded, stainless steel ring nut<br>M12 connectors A-Coding serie 763 | Pole           | 4             |
|              |   | Article number | 79 3429 52 04 |

illustration

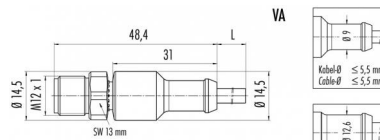

scale drawing



Contact Arrangement

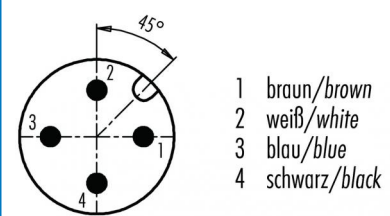

Attenuation characteristic

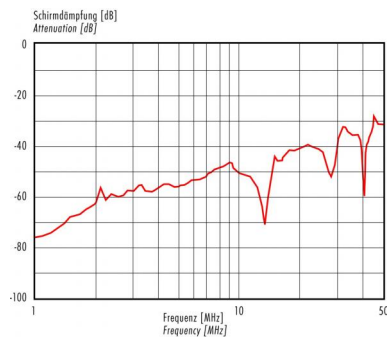

Technical data

Common values

|                          |                             |
|--------------------------|-----------------------------|
| Connector Design         | Male cable connector        |
| Connector locking system | Screw                       |
| Termination              | crimp, overmoulded on cable |
| Wire gauge (mm)          | 0,34 mm <sup>2</sup>        |
| Wire gauge (AWG)         | 22                          |
| Upper temperature        | +85 °C                      |
| Lower temperature        | -25 °C                      |

Electrical values

|                       |                    |
|-----------------------|--------------------|
| Rated voltage         | 250 V              |
| Rated impulse voltage | 2500 V             |
| Pollution degree      | 3                  |
| Overvoltage category  | II                 |
| Material group        | II                 |
| Rated current (40°C)  | 4 A                |
| Volume resistivity    | ≤ 3 mΩ             |
| Degree of protection  | IP 68              |
| Mechanical operation  | >100 mating cycles |

Material

|                          |              |
|--------------------------|--------------|
| Material of contact      | CuZn (brass) |
| Contact plating          | Au (gold)    |
| Material of contact body | PUR          |
| Material of housing      | PUR          |

Cable data

|  |          |
|--|----------|
| material housing                       | PUR      |
| insulation single lead                 | PVC      |
| single lead structure                  | 42 x 0,1 |
| cable sheath Ø                         | 5        |
| conductor resistance                   | 55Ω/Km   |
| temperature range cable movable c from | -5       |
| temperature range cable movable c to   | 70       |
| temperature range cable fixed c from   | -25      |
| temperature range cable fixed c to     | 70       |
| bending radius cable fixed             | 25 mm    |
| bending radius cable movable           | 50 mm    |

Contacts 4: Cable lenght 2 m, cable 4 x 0,34 PUR, male cable connector moulded, stainless steel ring nut

