

| | | | | |
|--------------|------------------------------------------------------------------|-----------|---------------------|--------------------|
| Product Area | Male socket, front fastened, IP 67 Push-Pull connectors IP 67 | serie 440 | Pole Article number | 8 09 4831 80 08 |
|--------------|------------------------------------------------------------------|-----------|---------------------|--------------------|

illustration

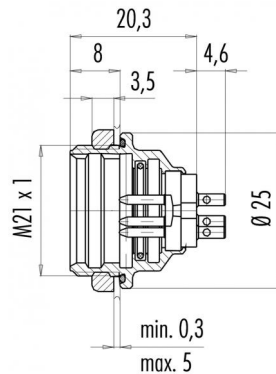

scale drawing



Contact Arrangement

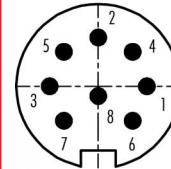

| | X | Y |
|---|-------|-------|
| 1 | 3,50 | 0,00 |
| 2 | 0,00 | 3,50 |
| 3 | -3,50 | 0,00 |
| 4 | 2,47 | 2,47 |
| 5 | -2,47 | 2,47 |
| 6 | 2,47 | -2,47 |
| 7 | -2,47 | -2,47 |
| 8 | 0,00 | -0,70 |

You can find the item description and assembly instruction on the next page.

Technical data

Common values

| | |
|--------------------------|----------------------|
| Connector Design | Male socket |
| Connector locking system | Push-Pull locking |
| Termination | solder |
| Wire gauge (mm) | 0,75 mm ² |
| Wire gauge (AWG) | 20 |
| Cable outlet | - |
| Upper temperature | +85 °C |
| Lower temperature | -40 °C |

Material

| | |
|--------------------------|----------------------------|
| Material of contact | CuZn (brass) |
| Contact plating | Au (gold) |
| Material of contact body | PBT (UL 94 V-0) |
| Material of housing | CUZn (brass nickel plated) |

Cable data

Contacts 8 DIN, male socket IP 67, front fastened

Electrical values

| | |
|-----------------------|---------------------|
| Rated voltage | 60 V |
| Rated impulse voltage | 500 V |
| Pollution degree | I |
| Overvoltage category | I |
| Material group | III |
| Rated current (40°C) | 5 A |
| Volume resistivity | ≤ 3 mΩ |
| EMV compliance | not shielded |
| Degree of protection | IP 67 |
| Mechanical operation | >1000 mating cycles |

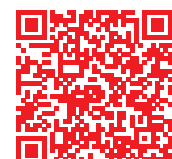

Product Male socket, front fastened, IP 67
 Area Push-Pull connectors IP 67

serie 440

Pole 8
 Article number 09 4831 80 08

Date: 2014-07-20 - Page 2 of 2

Item description

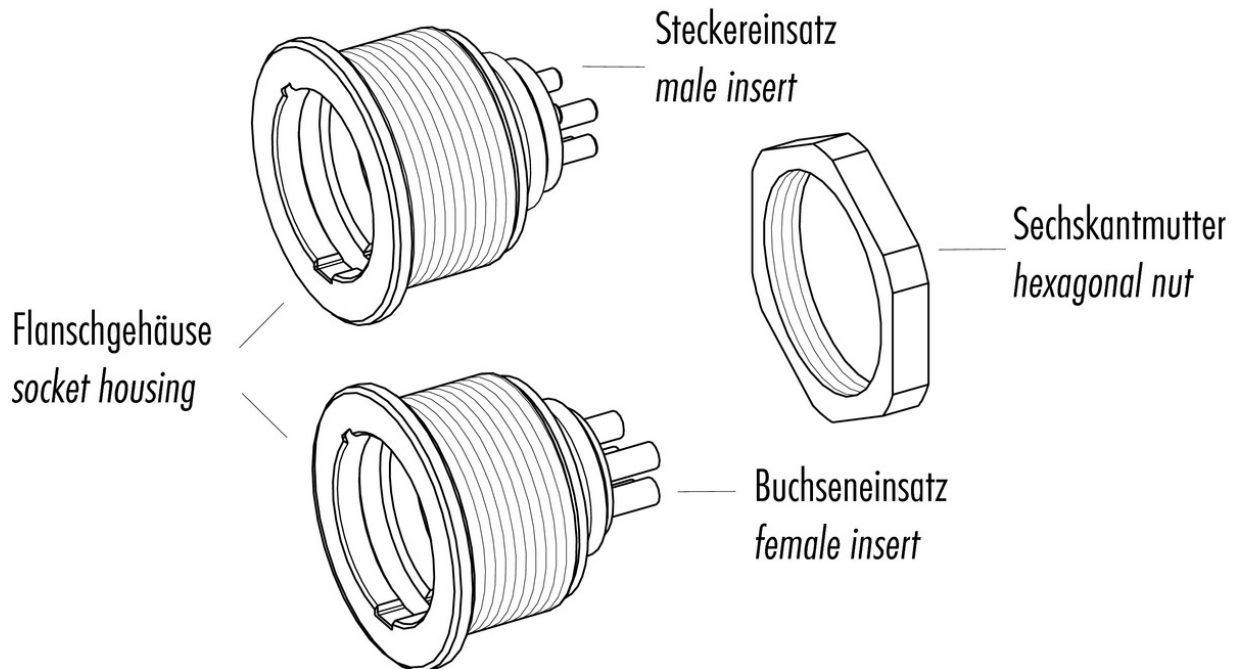

Installation instructions / Mounting cutout

