

Product	Male socket shielded IP 67	Pole	8 DIN
Area	Push-Pull connectors IP 67	Article number	09 4831 00 08
	serie 440		

illustration

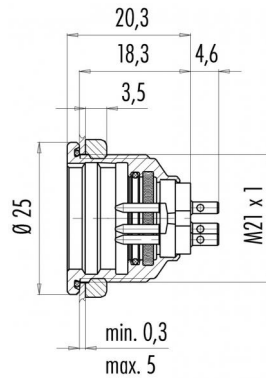

scale drawing



Contact Arrangement

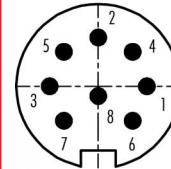

	X	Y
1	3,50	0,00
2	0,00	3,50
3	-3,50	0,00
4	2,47	2,47
5	-2,47	2,47
6	2,47	-2,47
7	-2,47	-2,47
8	0,00	-0,70

You can find the item description and assembly instruction on the next page.

Technical data

Common values

Connector Design	Male socket
Connector locking system	Push-Pull locking
Termination	solder
Wire gauge (mm)	0,75 mm ²
Wire gauge (AWG)	20
Cable outlet	-
Upper temperature	+85 °C
Lower temperature	-40 °C

Material

Material of contact	CuZn (brass)
Contact plating	Au (gold)
Material of contact body	PBT (UL 94 V-0)
Material of housing	CUZn (brass nickel plated)

Cable data

Contacts 8 DIN, male socket IP 67, shielded

Electrical values

Rated voltage	60 V
Rated impulse voltage	500 V
Pollution degree	1
Overvoltage category	I
Material group	III
Rated current (40°C)	5 A
Volume resistivity	≤ 3 mΩ
EMV compliance	shielded
Degree of protection	IP 67
Mechanical operation	>1000 mating cycles

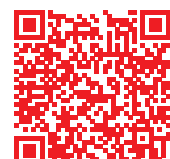

Product Area	Male socket shielded IP 67 Push-Pull connectors IP 67	serie 440	Pole Article number	8 DIN 09 4831 00 08
--------------	--	-----------	---------------------	------------------------

Date: 2014-07-20 - Page 2 of 2

Item description

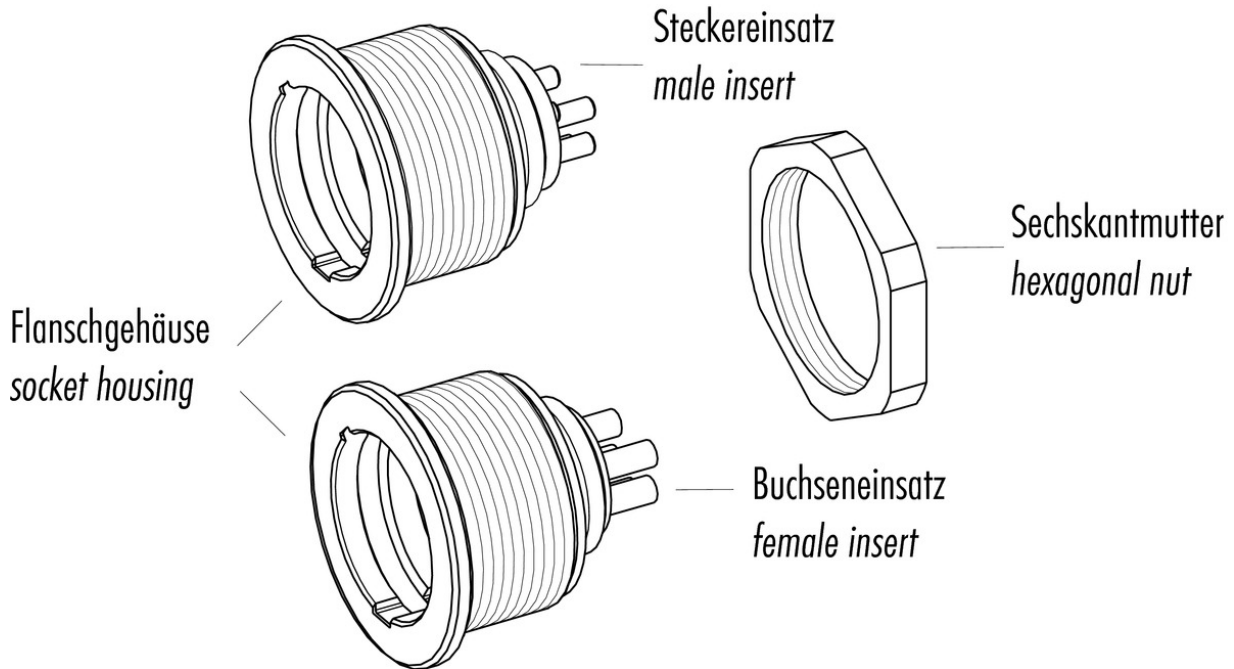

Installation instructions / Mounting cutout

