

| | | | |
|--------------|--------------------------------------------------------------------------------------------------------------|----------------|----------------|
| Product Area | Male socket, positioning possible, with wires, 0,25 mm ² M12 connectors A-Coding serie 713/763 | Pole | 8 |
| | | Article number | 09 3481 722 08 |

illustration

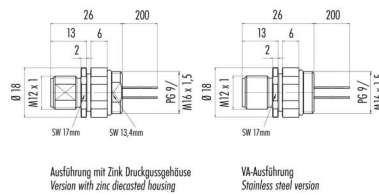

scale drawing



Contact Arrangement

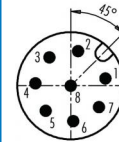

| geschirmt/ shielded | nicht geschirmt/ not shielded |
|-------------------------------------|----------------------------------|
| 1 weiß/white | 1 weiß/white |
| 2 braun/brown | 2 braun/brown |
| 3 grün/green | 3 grün/green |
| 4 gelb/yellow | 4 gelb/yellow |
| 5 grau/grey | 5 grau/grey |
| 6 rosa/pink | 6 rosa/pink |
| 7 blau/blue | 7 blau/blue |
| 8 Gehäuse-Schirm/ Housing-shield | 8 Schirm/shield |

You can find the assembly instruction on the next page.

Technical data

Common values

| | |
|--------------------------|----------------------|
| Connector Design | Male socket |
| Connector locking system | Screw |
| Termination | wires |
| Wire gauge (mm) | 0,25 mm ² |
| Wire gauge (AWG) | 24 |
| Upper temperature | +85 °C |
| Lower temperature | -40 °C |

Material

| | |
|--------------------------|--------------------------------|
| Material of contact | CuZn (brass) |
| Contact plating | Au (gold) |
| Material of contact body | PA |
| Material of housing | zinc diecasting, nickel plated |

Cable data

Contacts 8: Male socket, positioning possible, with wires, 0,25 mm², M16 x 1,5

Electrical values

| | |
|-----------------------|--------------------|
| Rated voltage | 60 V |
| Rated impulse voltage | 800 V |
| Pollution degree | 3 |
| Overvoltage category | II |
| Material group | II |
| Rated current (40°C) | 2 A |
| Volume resistivity | ≤ 3 mΩ |
| Degree of protection | IP 68 |
| Mechanical operation | >100 mating cycles |



Product Area Male socket, positioning possible, with wires, 0,25 mm²
M12 connectors A-Coding serie 713/763

Pole 8
Article number 09 3481 722 08

Date: 2014-07-20 - Page 2 of 2

Installation instructions / Mounting cutout

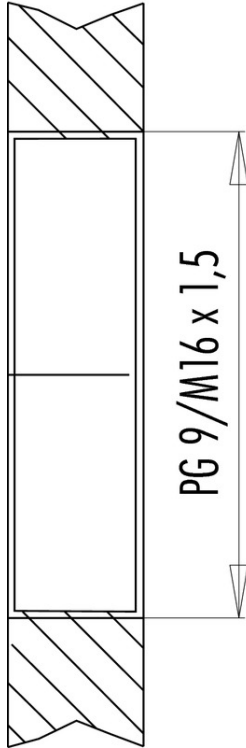

Anzugsdrehmoment/Tightening moment
6,25 Nm