

Product Area	Flanschdose, löten M16 connectors IP 67	serie 423/ 723/ 425	Pole Article number	24 09 0498 00 24
--------------	--	---------------------	---------------------	---------------------

illustration

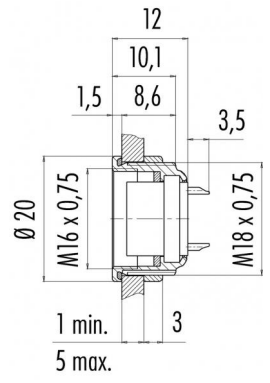

scale drawing



Contact Arrangement

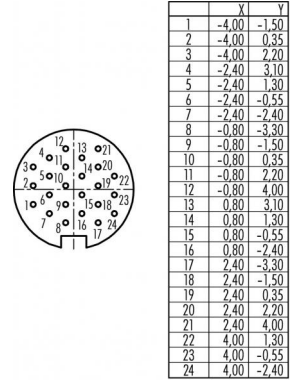

You can find the assembly instruction on the next page.

Technical data

Common values

Connector Design	Female socket
Connector locking system	Screw
Termination	solder
Wire gauge (mm)	0,14 mm ²
Wire gauge (AWG)	26
Upper temperature	+95 °C
Lower temperature	-40 °C

Material

Material of contact	CuSn (bronze)
Contact plating	Au (gold)
Material of contact body	PBT (UL 94 V-0)
Material of housing	zinc diecasting, nickel plated

Electrical values

Rated voltage	60 V
Rated impulse voltage	500 V
Pollution degree	I
Overvoltage category	I
Material group	III
Rated current (40°C)	1 A
Volume resistivity	≤ 3 mΩ
EMV compliance	shielded
Degree of protection	IP 67
Mechanical operation	>500 mating cycles

Cable data

Contacts 24, female socket, solder, 24
Contacts, gold plated contacts



Product
Area

Flanschdose, löten
M16 connectors IP 67

serie 423/ 723/ 425

Pole
Article number

24
09 0498 00 24

Installation instructions / Mounting cutout

