

Product Area	Female socket M 25 connectors	serie 691	Pole	3
			Article number	09 0036 00 03

illustration

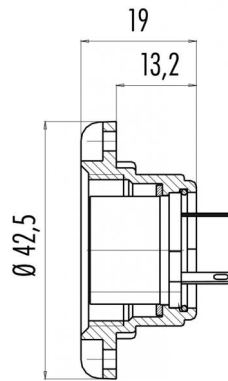

scale drawing



Contact Arrangement

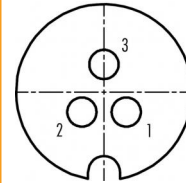

	X	Y
1	2,39	-2,14
2	-2,39	-2,14
3	0,00	3,00

You can find the assembly instruction on the next page.

Technical data

Common values

Connector Design	Female socket
Connector locking system	Screw
Termination	solder
Wire gauge (mm)	1,50 mm ²
Wire gauge (AWG)	16
Cable outlet	-
Upper temperature	+85 °C
Lower temperature	-40 °C

Material

Material of contact	CuSn (bronze)
Contact plating	Ag (silver)
Material of contact body	PBT (UL 94 V-0)
Material of housing	Gd-Al (eloxadized)

Cable data

Contacts 3, female socket

Electrical values

Rated voltage	250 V
Rated impulse voltage	2500 V
Pollution degree	I
Overvoltage category	II
Material group	III
Rated current (40°C)	10 A
Volume resistivity	≤ 5 mΩ
EMV compliance	not shielded
Degree of protection	IP 40
Mechanical operation	>500 mating cycles



Product
Area

Female socket
M 25 connectors

serie 691

Pole
Article number

3
09 0036 00 03

Installation instructions / Mounting cutout

