

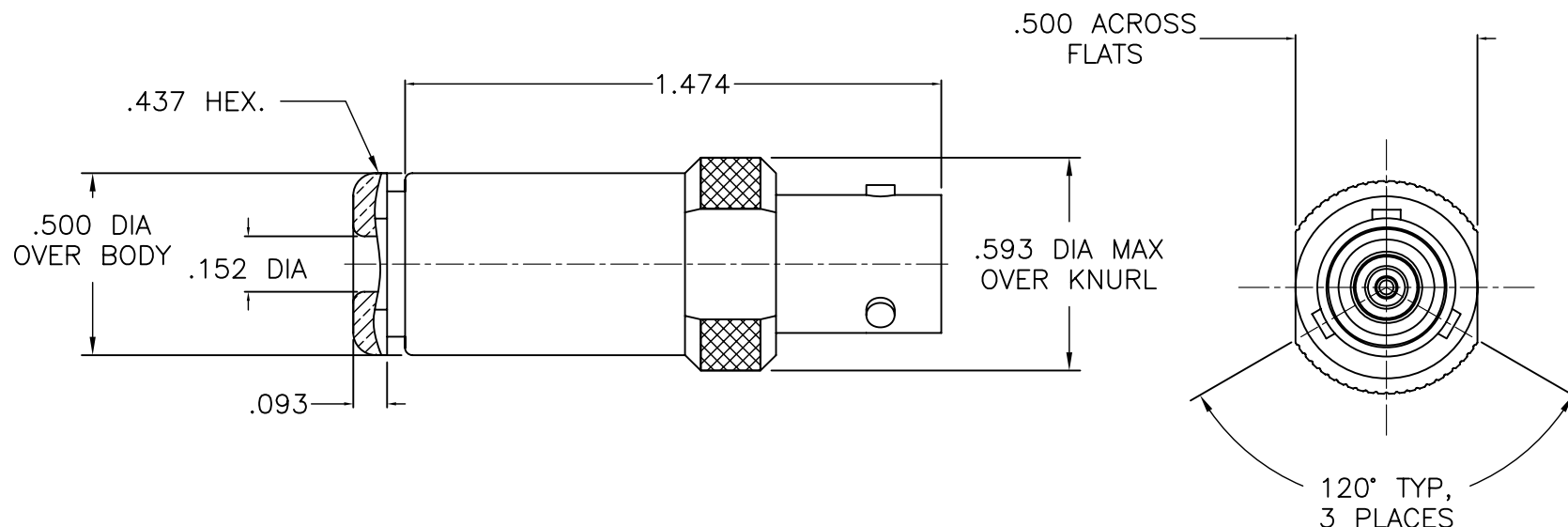

2008-235-N001



NOTES:

1. ASSEMBLED CONNECTOR INTERFACE IS DESIGNED IN ACCORDANCE WITH MIL-STD-348.
2. MATERIAL: INSULATORS - TEFLON PER ASTM D1710
GASKETS - SILICONE RUBBER PER ZZ-R-765
CONTACT - BERYLLIUM COPPER PER ASTM B196.
ALL OTHER METAL PARTS - BRASS PER ASTM B16.
3. FINISHES: CONTACT & INNER BODY - GOLD PLATE PER MIL-G-45204
ALL OTHER METAL PARTS - NICKEL PLATE PER QQ-N-290

UNLESS OTHERWISE SPECIFIED: TOLERANCES: 3 PLACES = $\pm .005$, 2 PLACES = $\pm .02$, ANGLES = $\pm 1/2^\circ$, SURFACE FINISH = 63

-	OUTLINE	5/30/08
ALT.	REVISIONS	DATE

THESE DRAWINGS AND SPECIFICATIONS ARE THE PROPERTY OF DELTA ELECTRONICS MFG CORP. AND SHALL NOT BE REPRODUCED, OR COPIED OR USED AS THE BASIS FOR THE MANUFACTURE OR SALE OF APPARATUS OR DEVICES WITHOUT THEIR EXPRESS WRITTEN CONSENT.

DELTA ELECTRONICS MFG. CORP. Beverly, MA 01915

TITLE: T.R.B. (3 LUG) CLAMP PLUG FOR
FOR M17/176-00002

Drawn by ADK	Scale 4/1	Ckd. by	Engr Appd	FILE NAME: 2008235N001-000T
-----------------	--------------	---------	-----------	--------------------------------

CODE IDENT.-00795

2008-235-N001