

Right Angle Printed-Circuit Board Jack Receptacle

Figure 1
(Through-hole mount)

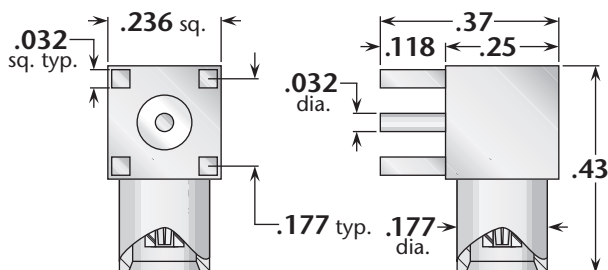

Figure	Max. Board Thickness	Mounting Figure	Plating		Delta P/N
			Body	Contact	
1	.062	PCB07	Gold*	Gold (C)	9869-000-G001-500

Printed-Circuit Board Plug Receptacles

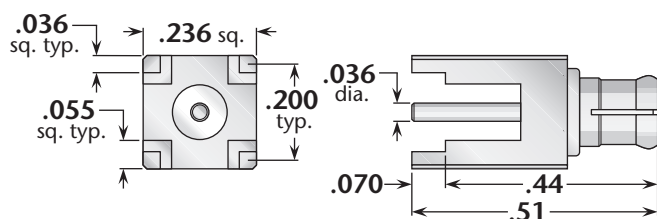

Figure 1
(Straight—through-hole mounting)

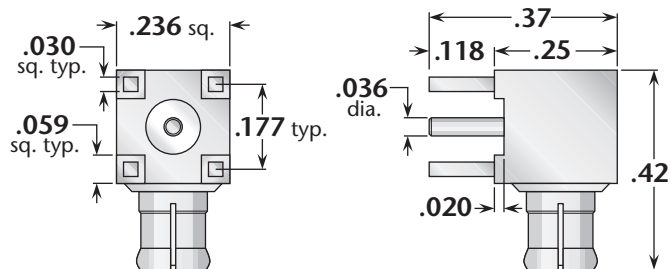
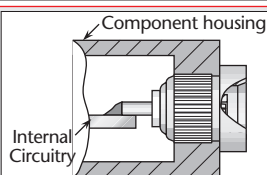

Figure 2
(Right angle—through-hole mounting)

Figure	Max. Board Thickness	Mounting Figure	Plating		Delta P/N
			Body	Contact	
1	.050	PCB06	Gold*	Gold (C)	9868-000-G001-500
2	.062	PCB07	Gold*	Gold (C)	9870-000-G001-500

PressMount Receptacles



Delta PressMount Receptacles

These connectors eliminate the need for complicated mounting hole patterns and mounting hardware. They are simply pressed into a single through hole, and the precisely-engineered knurled mounting section provides retention strength far greater than normal mating and unmating forces. An integral shoulder provides a positive stop when mounting.

Figure 1 (Post contact)

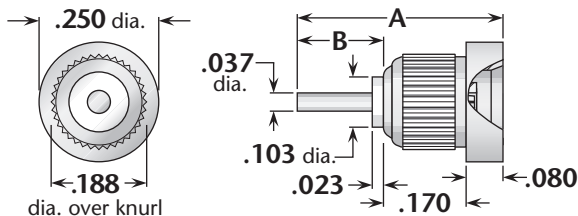

Figure	Dimensions		Min. Panel	Mounting Hole	Plating		Delta P/N
	A	B			Body	Contact	
1	.40	.15	.100	.184 ±.001 dia.	Gold*	Gold (C)	9820-000-G911-1
1	.73	.48	.100	.184 ±.001 dia.	Gold*	Gold (C)	9820-000-G911-8

* Also available with nickel-plated body—change G in Delta part number to N. • See page 203 for mounting dimensions.
(C) in contact plating column indicates captive contact.