

Panel Jack Receptacles—Post Contact

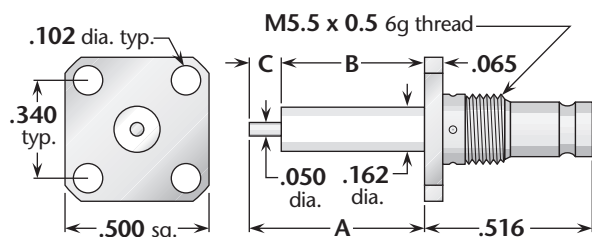

Figure 1 (1/2" square flange)

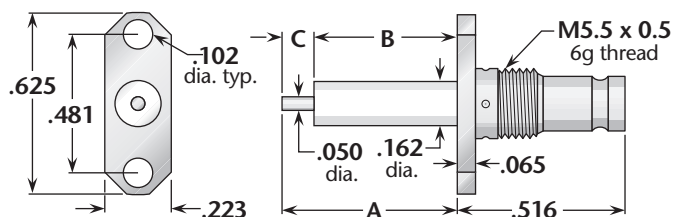
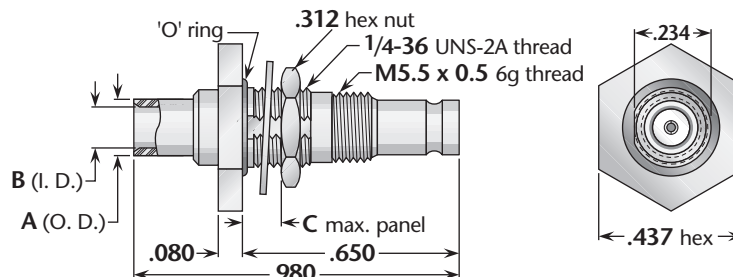

Figure 2 (2-hole flange)

Figure	Dimensions			Plating		Delta P/N
	A	B	C	Body	Contact	
1	.705	.590	.115	Gold	Gold (C)	4258-000-G051
1	.250	.150	.100	Gold	Gold (C)	4258-000-G051-10
2	.705	.590	.115	Gold	Gold (C)	4258-000-G921-2
2	.250	.150	.100	Gold	Gold (C)	4258-000-G921-3

Bulkhead Jacks—Direct Solder for Semi-Rigid Cable



Cable Group	Dimensions			Mounting Figure	Plating		Delta P/N
	A	B	C		Body	Contact	
13	.184	.145	.125	67	Gold	Gold	4217-031-G673
14	.120	.088	.125	67	Gold	Gold	4217-025-G673

Assembly Procedure

- 1) Trim cable as shown.
Remove any burrs from jacket and center conductor.
Tin center conductor.

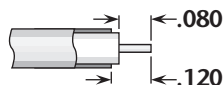

- 2) Solder contact to center conductor, with end of contact flush with cable dielectric.
Remove any excess solder from outside of contact.



- 3) Insert cable into body until end of cable jacket stops against internal shoulder.
Solder cable jacket to body.

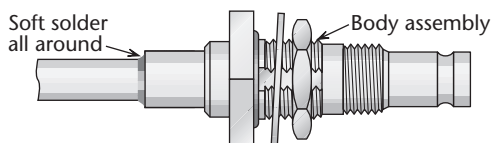

Receptacles also available with other contact / insulator configurations. • (C) in contact plating column indicates captive contact.
See page 203 for mounting figures. • See page 204 for cable groups.