

## General Description

Delta MQD (Miniature QDS) connectors feature the same positive-locking, push-on mating as QDS series connectors, but in a miniature size equivalent to BNC and TNC connectors. Along with the convenience of quick-connect and quick-disconnect mating, they exhibit good VSWR to 9 GHz.

Our MiniQDS series product line is still growing, so please call if you don't see what you need.

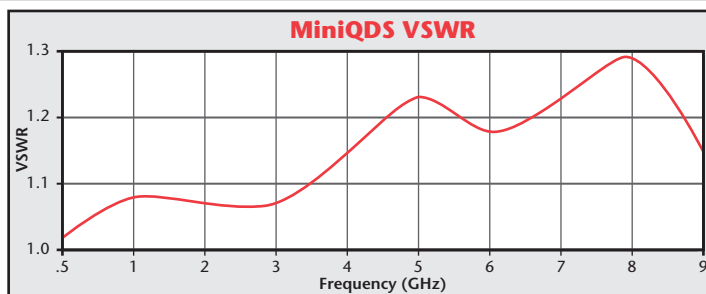

Contact factory for other specifications and interface dimensions.

## Straight Plug—Crimp Type for Flexible Cable

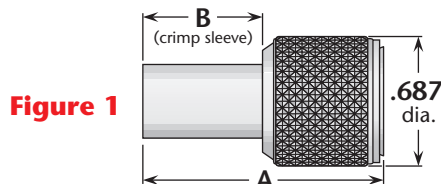

Cable Group	Figure	Dimensions		Plating		Delta P/N	Assembly Procedure/Trim Code
		A	B	Body	Contact		
6	1	1.05	.50	Albaloy*	Gold	4203-015-Q000	B/23

\* Crimp sleeve is nickel plated.

## Panel Jack Receptacle—Square Flange

**Figure 1**  
(Solder pot contact)

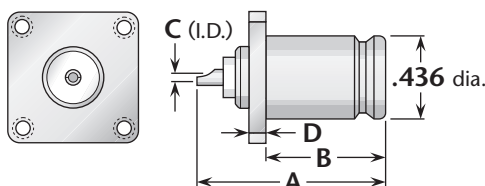

Also available with other contact/insulator configurations and flange sizes

Figure	Dimensions				Mounting Figure	Plating		Delta P/N
	A	B	C	D		Body	Contact	
1	1.06	.63	.062	.090	07	Albaloy	Gold (C)	4213-000-Q071-1

## Adapter Between Series

**Figure 1**  
(MiniQDS jack to TNC jack)

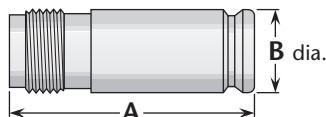

Figure	Dimensions		Plating		Delta P/N
	A	B	Body	Contact	
1	1.28	.436	Albaloy	Gold (C)	2234-000-Q001-136

See page 204 for cable groups. • Assembly procedures start on page 205. • See page 203 for mounting dimensions.  
(C) in contact plating column indicates captive contact. • See page 6 for alternate body plating information.