

General Description

Delta MQD (Miniature QDS) connectors feature the same positive-locking, push-on mating as QDS series connectors, but in a miniature size equivalent to BNC and TNC connectors. Along with the convenience of quick-connect and quick-disconnect mating, they exhibit good VSWR to 9 GHz.

Our MiniQDS series product line is still growing, so please call if you don't see what you need.

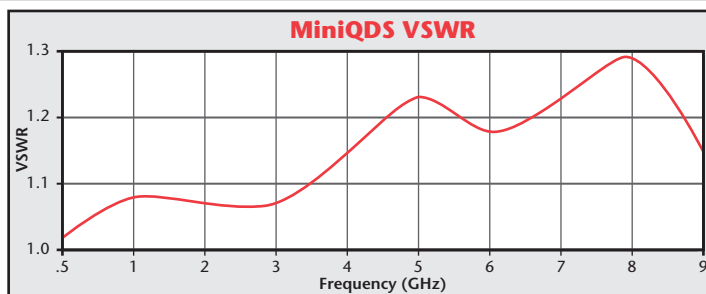

Contact factory for other specifications and interface dimensions.

Straight Plug—Crimp Type for Flexible Cable

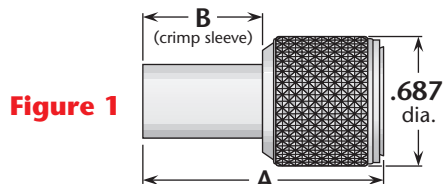

Cable Group	Figure	Dimensions		Plating		Delta P/N	Assembly Procedure/Trim Code
		A	B	Body	Contact		
6	1	1.05	.50	Albaloy*	Gold	4203-015-Q000	B/23

* Crimp sleeve is nickel plated.

Panel Jack Receptacle—Square Flange

Figure 1
(Solder pot contact)

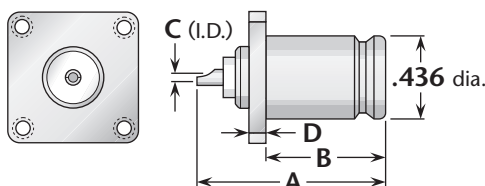

Also available with other contact/insulator configurations and flange sizes

Figure	Dimensions				Mounting Figure	Plating		Delta P/N
	A	B	C	D		Body	Contact	
1	1.06	.63	.062	.090	07	Albaloy	Gold (C)	4213-000-Q071-1

Adapter Between Series

Figure 1
(MiniQDS jack to TNC jack)

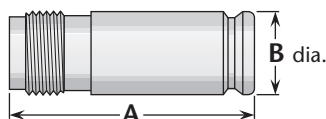

Figure	Dimensions		Plating		Delta P/N
	A	B	Body	Contact	
1	1.28	.436	Albaloy	Gold (C)	2234-000-Q001-136

See page 204 for cable groups. • Assembly procedures start on page 205. • See page 203 for mounting dimensions. (C) in contact plating column indicates captive contact. • See page 6 for alternate body plating information.