

## Adapters—SMA Jack to Other Series

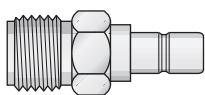

**Figure 1**  
(SMA jack-SMB jack)

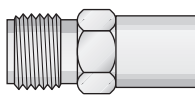

**Figure 2**  
(SMA jack-SMB plug)

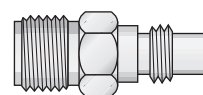

**Figure 3**  
(SMA jack-SMC jack)

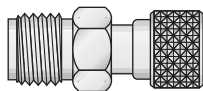

**Figure 4**  
(SMA jack-SMC plug)

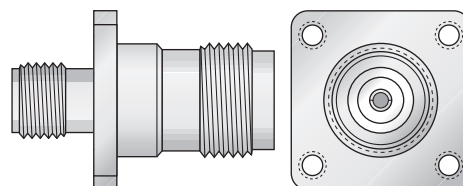
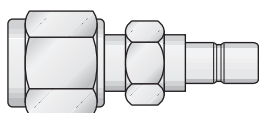

**Figure 5**  
(SMA jack-TNC jack)

Figure	Adapter Ends	Length	Mounting Figure	Plating		Delta P/N
				Body	Contact	
1	SMA jack-SMB jack	.65	None	Nickel	Gold (C)	2234-000-N001-78
2	SMA jack-SMB plug	.64	None	Nickel	Gold (C)	2228-000-N001-15
3	SMA jack-SMC jack	.65	None	Nickel	Gold (C)	2234-000-N001-121
4	SMA jack-SMC plug	.69	None	Nickel	Gold (C)	2234-000-N001-77
5	SMA jack-TNC jack	1.00	07	PSS*	Gold (C)	2225-000-K071-2

\* Passivated stainless steel.

## Adapters—SMA Plug to Other Series



**Figure 1**  
(SMA plug-SMB jack)

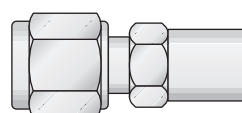

**Figure 2**  
(SMA plug-SMB plug)

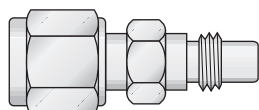

**Figure 3**  
(SMA plug-SMC jack)

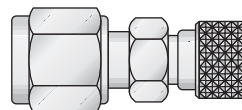

**Figure 4**  
(SMA plug-SMC plug)

Figure	Adapter Ends	Length	Mounting Figure	Plating		Delta P/N
				Body	Contact	
1	SMA plug-SMB jack	.81	None	Nickel	Gold (C)	2234-000-N001-82
2	SMA plug-SMB plug	.88	None	Nickel	Gold (C)	2234-000-N000-69
3	SMA plug-SMC jack	.81	None	Nickel	Gold (C)	2234-000-N001-120
4	SMA plug-SMC plug	.82	None	Nickel	Gold (C)	2234-000-N001-81

See page 203 for mounting dimensions. • (C) in contact plating column indicates captive contact.  
See page 6 for alternate body plating information.